

## CUSTOMER SERVICE CARDS

*Chopard*



This Chopard product is **NOT** water-resistant; therefore avoid contact with water or moisture.



Customer Service #1 04/2016

*Chopard*



This Chopard product is water-resistant (ISO 22810), and covers all ordinary aquatic activities. To ensure water resistance, make sure that the crown and/or pushers are fully pushed in, or screwed down before any aquatic activities.

To preserve the leather appearances and its suppleness, leather strap band should not be immersed in water.



Customer Service #2 04/2016

Chopard

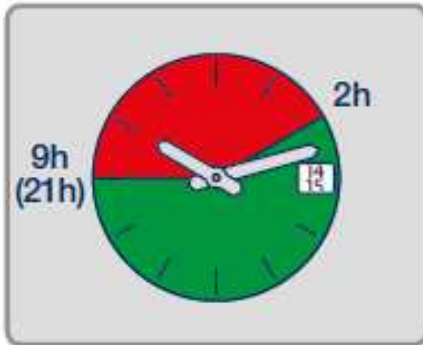

To avoid damaging the date mechanism function, do **NOT** adjust it between 09:00 PM & 02:00 AM.

Customer Service #3

04/2016

Chopard

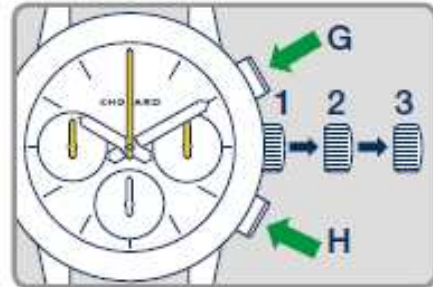

To set the chronograph hands to zero, pull out the crown to **position 2 or 3**, and activate pushers G or H accordingly.



Customer Service #4

04/2016

Chopard

## SELF-WINDING



To restart your watch's mechanism and set the appropriate time, the movement must be manually wound by turning the crown **CLOCKWISE** until it runs.

To ensure optimal winding and running of the movement, a self-winding movement watch must be worn daily.



Customer Service #5

04/2016

Chopard

## SPECIFIC SELF-WINDING



To restart your watch's mechanism and set the appropriate time, this Chopard specific movement must be manually wound by turning the crown **ANTI-CLOCKWISE** until it runs.

To ensure optimal winding and running of the movement, a self-winding movement watch must be worn daily.



Customer Service #6

04/2016

*Chopard*

## MANUAL WINDING



To restart your watch's mechanism and set the appropriate time, the movement must be manually wound by turning the crown **CLOCKWISE** until it runs.

To ensure optimal running of the movement, a manual winding watch should be wound daily.



Customer Service #7

04/2016